

New Danfoss Valve Mount Plate SB401

Description

The plate to which the Danfoss hydraulic control valve bank mounts and the adjacent area of the crane base on the SB401 family of cranes has been redesigned to allow better access to the valve bank.

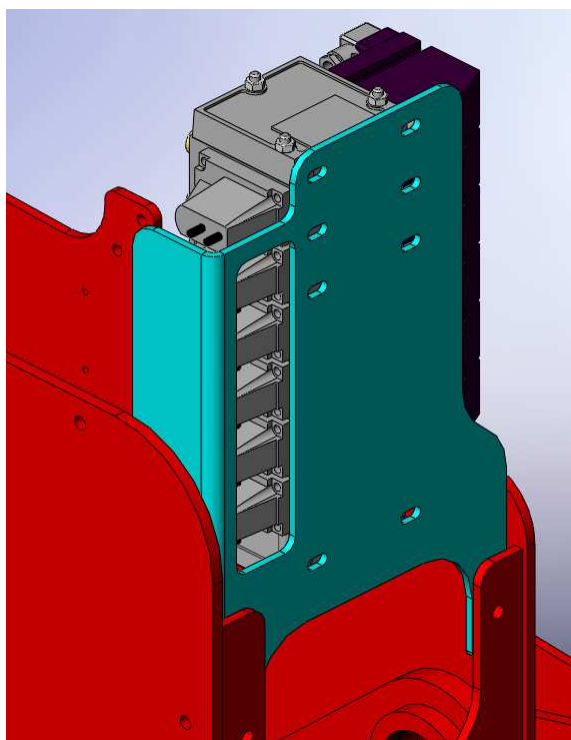

Existing/Old Version

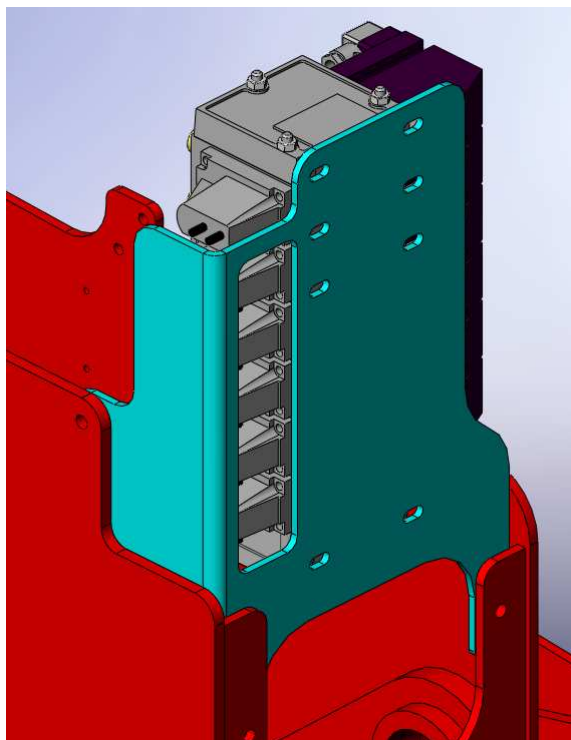

New Version

Models and Markets

All variants of SB361, SB401, SE402

BOM

Plate Mounting Danfoss Valve RH Crane: S8-39734R replaces S8-33620

Plate Mounting Danfoss Valve LH Crane: S8-39734L replaces S8-33633

The crane base structure part numbers are unchanged.

Backward Compatibility

This change is not backward compatible so the old valve bank mounting plates will continue to be available for spare parts use.

New Danfoss Valve Mount Plate SB401

Use Instructions

N/A

Benefits and Advantages to Change

The reason for this change is to improve serviceability of the SB401 sidelifter. If the mounting plate is removed the spools in the valve bank will be accessible without having to remove the valve bank from the crane. Although the pipes that run to and from the valve bank will hold it in place, it is recommended that a suitable block is positioned below the valve bank to help support it while the mounting plate is not fitted.

References

EC1522